

PROJECT:	Wells County Public Library Renovations	SUPPLEMENTAL INFORMATION (SI) NUMBER:	56R1
		DATE OF ISSUE:	6/19/2020
OWNER:	WCPL	CONTRACT FOR:	General Construction
		CONTRACT DATED:	12/9/2019
TO CONTRACTOR:	CME Corporation	ARCHITECT'S PROJECT NUMBER:	19067

Submit proposal or proceed with the Work as indicated below:

- ☒ Supplemental information issued as PROPOSAL REQUEST: Please submit an itemized proposal for changes in the Contract Sum and Contract Time for proposed modifications to the Contract Documents described herein. THIS IS NOT A CHANGE ORDER, A CONSTRUCTION CHANGE DIRECTIVE OR A DIRECTION TO PROCEED WITH THE WORK DESCRIBED IN THE PROPOSED MODIFICATIONS. Contractor to receive written approval by the Architect prior to commencing work.
- ☐ SUPPLEMENTAL INSTRUCTIONS shall be carried out in accordance with the modifications to the Contract Documents described herein issued in accordance with Contract Documents without change in Contract Sum or Contract Time. Proceeding with the Work in accordance with these instructions indicates your acknowledgement that there will be no change in the Contract Sum or Contract Time.
- ☐ The Work described in the supplemental information to be performed on a "TIME AND MATERIALS" (T&M) basis. Contractor to receive written approval by the Owner for the scope of work described herein prior to commencing work.

SUMMARY: NEW RAILING AT LOUNGE 201 / TIERED SEATING - REVISION 1
DESCRIPTION:

Contractor to provide cost to owner to install new railing per attached drawing SI-56.1 at LOUNGE 201.

Notes:

Contractor to match on-site conditions - shoe base cladding may be required to match existing conditions - include shoe base cladding in cost as needed.

Contractor to submit shop drawings for architect review prior to ordering and installation.

See revised drawing sheet SI 56.1 R1 referring to thru-bolting information: Contractor will have to install through bolts through counter-bored holes and tighten from below slab condition.

\$19,913.53 + GENERAL CONDITIONS (PCO #067) AS QUALIFIED BY SHOP DRAWING REQUIREMENT IN PCO #057

EXCLUDES ANY ADDITIONAL SHOP DRAWING COSTS FROM CRL OR ALL GLASS.

ASSUMES 2 WEEK LEAD TIME ON SHOP DRAWINGS FROM CRL.

ATTACHMENTS: SI-56.1 Drawing
ISSUED BY: Craig Campbell
CC: Andrew Hesterman, WCPL, CME, SCO

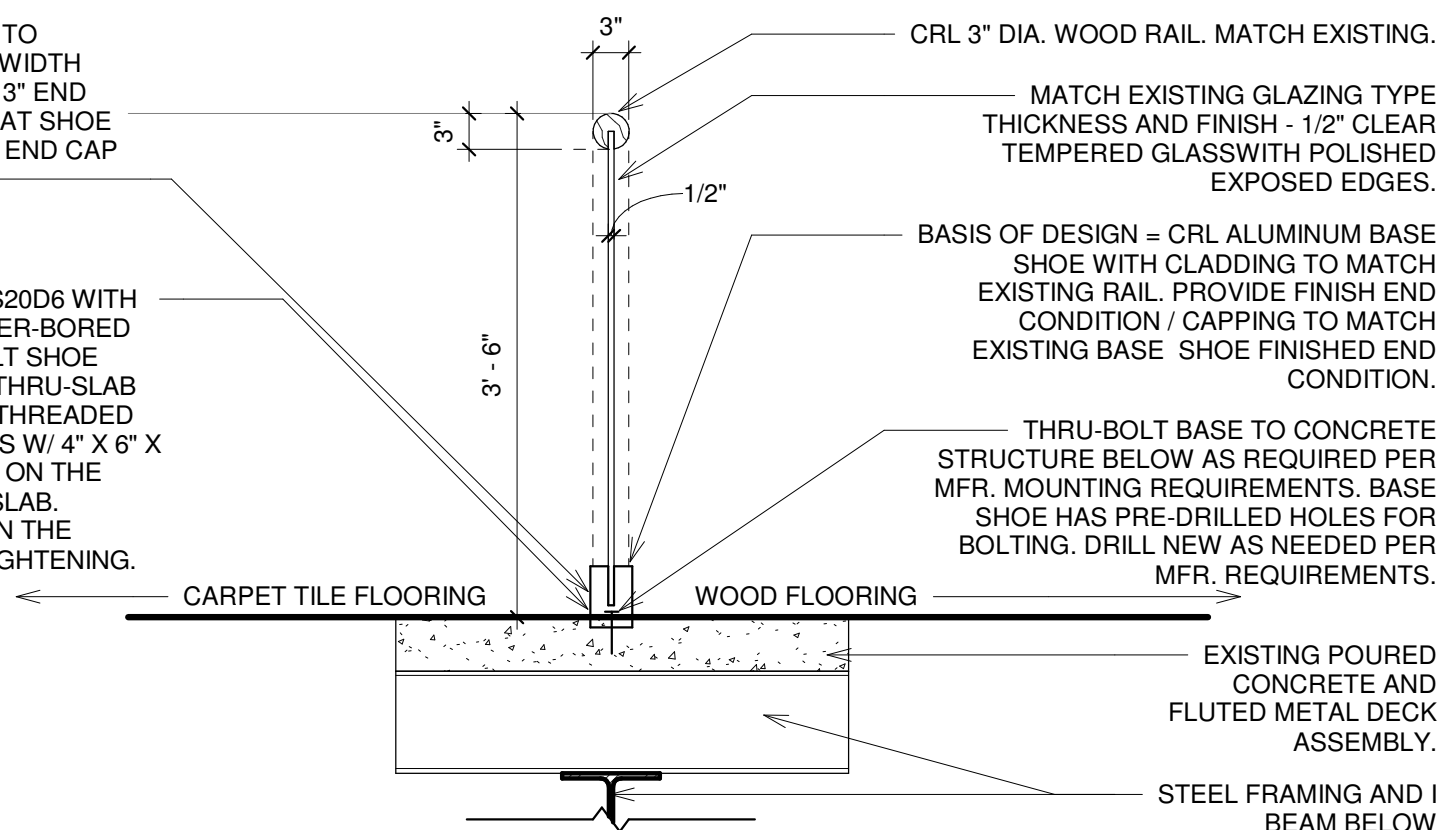

NEW RAILING SECTION

WOOD CAP RAIL AT RAIL SIDE
CONDITION. MATCH EXISTING
CRL. PRODUCT NO. AND FINISH.

MITERED TURN DOWN
FROM WOOD RAIL TO
WOOD CAP

CONTRACTOR F.V.
DIMENSION 5/18/2020

22' - 0"

5' - 0" STAIR

2' - 6"

19' - 6" NEW RAILING ASSEMBLY

EQ

EQ

EQ

EQ

EQ

EQUAL SPACING AT BUTT
JOINT CENTERLINES

RAILING ASSEMBLY
TERMINATES AT WALL.
SIMILAR TO EXISTING
ON-SITE
CONDITION.

3"

ROUND WOOD
RAIL. MATCH
EXISTING.

3' - 6"

4 1/4"

SHOE. MATCH
EXISTING

1/2" BUTT GLAZE JOINT. TYP.

1/2" CLEAR TEMPERED
GLASS WITH POLISHED
EXPOSED EDGES

CAP SHOE BASE AT END
CONDITION WITH SHOE
BASE END CAP TO
ENSURE FINISHED END
CONDITION.

DOWEL END CAP INTO
SHOE AT BASE TO
MATCH EXISTING ON-
SITE CONDITIONS.

SHOE BASE: CRL B5S20D6 WITH PRE-DRILLED COUNTER-
BORED HOLES AT 6" O.C. BOLT SHOE BASE TO SLAB WITH
THRU-SLAB ASTM F1554 1/2" DIA. THREADED ROD
THROUGH-BOLTS W/ 4" X 6" X 1/4" PLATE WASHERS ON THE
UNDERSIDE OF THE SLAB. INSTALL LOCK NUT ON THE
BOTTOM SIDE FOR TIGHTENING.

NEW RAILING ELEVATION

CONTRACTOR F.V. DIMENSION
5/18/2020

LOUNGE
201

STAIR TO WALL
22' - 0" CME F.V. DIMENSION

19' - 6" NEW RAILING ASSEMBLY

3" WOOD RAIL (VERT)

EQ EQ EQ EQ

~ 5' - 0" (STAIR)

2' - 6"

6"

1' - 0"

FLOOR SLAB EDGE & CARPET-TO-WOOD FLR FINISH TRANSITION

2
ISI-56.1

201

EQUAL SPACING AT BUTT JOINT CENTERLINES

RAILING ASSEMBLY TERMINATES AT WALL. SIMILAR TO EXISTING ON-SITE CONDITION.

SHOE BASE: CRL B5S20D6 WITH PRE-DRILLED COUNTER-BORED HOLES AT 6" O.C. BOLT SHOE BASE TO SLAB WITH THRU-SLAB ASTM F1554 1/2" DIA. THREADED ROD THROUGH-BOLTS W/ 4" X 6" X 1/4" PLATE WASHERS ON THE UNDERSIDE OF THE SLAB. INSTALL LOCK NUT ON THE BOTTOM SIDE FOR TIGHTENING.

NEW RAILING PLAN

NEW RAILING PLAN

6/19/2020 10:00:07 AM



CME Corporation
7235 Vicksburg Pike
Fort Wayne, 46804
Phone: (260) 745-0251

Project: 19218 - Wells County Public Library Interior Renovation
200 W Washington St
Bluffton, Indiana 46714

Prime Contract Potential Change Order #057: CE #114 - SI-56.1 - New Glass Railing at Tiered Seating

TO:	Wells County Public Library 200 W Washington Street Bluffton Indiana, 46714	FROM:	CME Corporation 7235 Vicksburg Pike Fort Wayne Indiana, 46804
PCO NUMBER/REVISION:	057 / 0	CONTRACT:	1 - Wells County Public Library Interior Renovation
REQUEST RECEIVED FROM:	Andrew Hesterman (MKM architecture + design)	CREATED BY:	Sean Hayes (CME Corporation)
STATUS:	Pending - In Review	CREATED DATE:	7/7 /2020
REFERENCE:	PCO #067	PRIME CONTRACT CHANGE ORDER:	None
FIELD CHANGE:	Yes		
LOCATION:	201 Lounge	ACCOUNTING METHOD:	Amount Based
SCHEDULE IMPACT:	92 days	PAID IN FULL:	No
		TOTAL AMOUNT:	\$19,913.53

POTENTIAL CHANGE ORDER TITLE: CE #114 - SI-56.1 - New Glass Railing at Tiered Seating

CHANGE REASON: Client Request

POTENTIAL CHANGE ORDER DESCRIPTION: *(The Contract Is Changed As Follows)*

CE #114 - SI-56.1 - New Glass Railing at Tiered Seating

SI-56 - New Glass Railing at Tiered Seating

- Assumes approval by 7/15
- Includes glass panels with wood railing and cladding at the base
- Includes vinyl on glass
- Includes shop drawing lead time of 2 weeks
- Includes 2 week shop drawing review period
- Shoe lead time is 30 days from approved shop drawings
- Glazing lead time is two weeks after base is installed
- Wood railing lead time is 2-3 weeks from approved shop drawings
- If shop drawings are required, general conditions apply (PCO #067) unless the substantial completion date is otherwise extended to October 14th. 13 weeks 1 day duration (92 calendar days).
- If shop drawings are NOT required, general conditions apply (PCO #067) unless the substantial completion date is otherwise extended to September 16th. 9 weeks 1 day duration (64 calendar days).

ATTACHMENTS:

[Estimate_4163 WCPL Hand Rail System 7-10-2020,1 Break down CME & ALL-GLASS.pdf](#) [BLUFF LIB OAK RAIL CAP.pdf](#) [_CDT Quote.pdf](#)
[Baldus SI-56 Quote.pdf](#) [_SI-56.1 - New Railing at Lounge 201.pdf](#)

#	Cost Code	Description	Type	Amount
1	08-08800 - Glazing	AG - SI-56 - Glass/base	Commitment	\$ 7,385.00
2		CME OH&P 5% on AG		\$ 369.25
3	12-12600 - Signage	BC - SI-56 - Vinyl Striping on Glass	Commitment	\$ 740.00
4		CME OH&P 5% on BC		\$ 37.00

5	09-09250 - Drywall/Painting/Column Enclosures	CDT - Staining of Wood Railing	Commitment	\$ 320.00
6		CME OH&P 5% on CDT		\$ 16.00
7		CME - Labor		\$ 2,261.54
8		CME - Materials		\$ 6,145.00
9		CME - Equipment		\$ 400.00
10	01-01715 - Waste Disposal	CME - Other	Other	\$ 100.00
11		CME - Supervision		\$ 868.00
12		CME - OH&P 10 on self-performed scope		\$ 977.45
13	01-01910 - P & P Bond	CME - Bond 1.5%	Other	\$ 294.29
Subtotal:				\$19,913.53
Grand Total:				\$19,913.53

	Rejected: Proceed per Original Contract
	Approved to Proceed with Work: Change Order Forthcoming
	Approved to Proceed with Work: Use Owner Contingency
	Other: _____
By:	Date:

All Glass, LLC

PO Box 8334

Ft. Wayne, IN 46898

260-410-0742

Dan Weingartner

Estimate

DATE	EST #
7-10-2020	4163 rev.

NAME / ADDRESS		
CME Corporation 7235 Vicksburg Pike Fort Wayne IN. 46804		
P.O. NO.	TERMS	PROJECT
		WCPL
DESCRIPTION		TOTAL
<p>We Propose to Supply/Install CRL TAPER-LOCK Dry Glazed Railing System as Follows.</p> <p>(1) 21'-1/2"long X 42" high. Shoe Base: 2-1/2" wide X 4-1/8" tall , CRL B5S Series. Glass: 1/2" Clear Tempered , Polished Edges. Clading: Clear anodized. Hardware: 10" Thru Bolts, Nuts, Washers.</p> <p>By Others: Penetration and termination of fasteners from shoe base thru concrete floor into steel structure below flooring, Wood Trims, Installation of wood trims, Saw Cutting of floor and embed steel, Installation of embed steel, Steel , Final Cleaning of Glass and Frames, Staining of wood top rail. Installation and cutting of wood top rail , Determination of wood species. Anything not listed above or excluded below.</p> <p>EXCLUDES WOOD RAILING, CRL MINIMUM ORDER OF (15) 10' SECTIONS REQUIRED. (ONLY (3) NEEDED)</p> <div><p>Material CME \$3,500.00</p><p>Material AG \$4,185.00</p><p>Labor AG \$3,200.00</p></div>		
Phone #	Fax #	E-mail
260-410-0742	260-489-9961	dwallglass@gmail.com
		TOTAL Base Bid \$10,885.00

Exclusions: Level and plumb rough openings, permits, bonds, cleaning of glass and frames, demolition, wood blocking, deligated design & engineering, structural calculations, mock ups, liquidated damages, final cleaning, protection of glass and frames, and anything not listed above.

Proposal

June 4, 2020



CME Corporation

Sean Hayes

Wells County Public Library Renovation -CE #093 – SI-56

Negotiated

Sean,

Thanks for the opportunity to provide the following pricing and specifications...

Frosted Vinylon New Railing

- Banded design to match existing
- Dusted Crystal etch vinyl applied across 4 glass panels
- On-site measurements to confirm dimensions
- Delivery and professional installation

Item Cost...\$740.00

Let me know if you have questions or would like to proceed.

Thanks.

Signature of Approval

Request for Quote #007: CE #114 - SI-56.1 - New Glass Railing at Tiered Seating

General Related Items (0) Emails (0) Change History (5)

GENERAL INFORMATION

Edit

Number:	007	Date Created:	06/30/20 at 03:24 pm
Created By:	Sean Hayes	Status:	Under Review
Title:	CE #114 - SI-56.1 - New Glass Railing at Tiered Seating	Change Event:	CE #114
Intent to quote:	Yes		
Due Date:	06/30/20		
Assignee:	Sweet, Jordan (Complete Drywall & Texture, Inc.)	Distribution:	
Scope Description:	CDT - Staining of Wood Railing		
Request Details:	<div>CE #114 - SI-56.1 - New Glass Railing at Tiered Seating SI-56 - New Glass Railing at Tiered Seating</div> <div><ul style="list-style-type: none">◦ Stain 3" dia. oak railing, 22' section & 3'-6" section. Stain to match as close a possible the existing adjacent oak railing.</div>		
Attachments:	📎SI-56.1 - New Railing at Lounge 201.pdf		

RESPONSES

Date	Response By	Quote Amount	Schedule Impact	Comments	Attachments/Details
06/30/20 at 03:25 pm	Sean Hayes	\$320.00	0 days	120 material 200 labor per call 6/30/2020 with Jordan	



Quote

Quote	July 13, 2020

Mill Work Division
PH (260)422-5584

2236 Wayne Trace, Fort Wayne, IN 46803
Fax (260)422-8681

ROB CARR

Page 1 of 1

Project Name	Attention	Contractor			
3" Red Oak Wood Railing	Sean T. Hayes	CME			
Amount	Material Description	Abb.	Item #	Price per	Extended Price
0	Custom Architectural Millwork for the following areas:			\$0.00	\$0.00
0	SI 56.1 R1			\$0.00	\$0.00
				\$0.00	\$0.00
	3" DIA RED OAK RAIL CAP WITH GROVE CUT OUT PER DRAWING PROVIDED			\$0.00	\$0.00
				\$0.00	\$0.00
1	TOTAL --			\$875.00	\$875.00
				\$0.00	\$0.00
				\$0.00	\$0.00
	NOTE: ITEM TO BE GLUED UP FOR THICKNESS			\$0.00	\$0.00
	WILL BE SENT FOR FIELD CUTTING AND ASSEMBLY.			\$0.00	\$0.00
				\$0.00	\$0.00
				\$0.00	\$0.00
				\$0.00	\$0.00
				\$0.00	\$0.00
0				\$0.00	\$0.00
				\$0.00	\$0.00
0				\$0.00	\$0.00
0				\$0.00	\$0.00
0				\$0.00	\$0.00
0				\$0.00	\$0.00
0				\$0.00	\$0.00
	Exclusions:			\$0.00	\$0.00
0	Installation			\$0.00	\$0.00
	Sales and use taxes			\$0.00	\$0.00
0	Staining / painting / finishing			\$0.00	\$0.00
0				\$0.00	\$0.00

Quotation prepared by:
Mill Work Estimator _____

Sub-Total	\$875.00
Tax	0.00%
Total	\$875.00
Labor	
Total	

Comments: Quote good for 30 Days. This estimate is designed solely to provide the contractor/consumer with a rough estimate of the amount of the material used in the given project. This material estimate will be based upon calculations of information provided by the contractor/customer, and such estimate assumes, among other things, normal and typical building and construction techniques. The actual amount of material used may vary from the material estimated due to a number of factors. Consequently, no representation or warranty has been made that the actual amount of material used will not vary from the estimate. There will be no returns on special ordered no-stocked items, manufactured/mill items, damaged, stained, non-reusable merchandise. Returnable items must be in resalable condition, complete, in the original package and accompanied by sales slip. Credits or refunds will be made at the price you paid for the product. Acceptance of the materials by the Buyer indicated his agreement to pay the rate of finance charge of specified (18%) annual percentage rate.

Thank you for the opportunity to quote this project!