

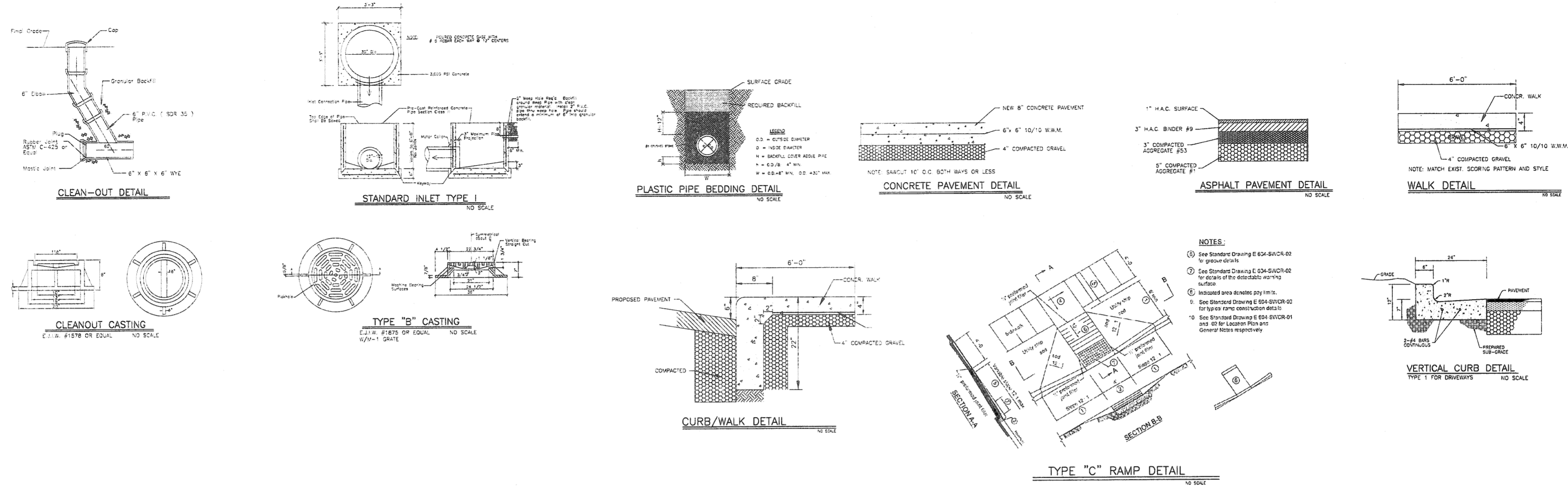

CERTIFICATION



All concepts, ideas, designs, plans and details as shown in this document are the sole property of Design Collaborative, Inc. and shall not be used for any purpose without their expressed written consent. The owner shall be permitted to retain copies for information and reference.



- NOTES:**
- See Standard Drawing E 624-SWCR-02 for groove details.
 - See Standard Drawing E 624-SWCR-02 for details of the detachable warning surface.
 - Indicated areas showing poly film.
 - See Standard Drawing E 624-SWCR-02 for types ramp construction details.
 - See Standard Drawing E 624-SWCR-01 and 02 for Location Plans and General Notes respectively.

SANITARY SEWER TAP CONSTRUCTION STANDARDS/SPECIFICATIONS

- All materials and workmanship shall meet the City of Bluffton Water Department Standards and Specifications, and Title 327 of the Indiana Administration Code, Article 3 (State Code).
- All Polyvinyl Chloride Pipe (PVC) shall conform to ASTM D-3034-87, D-1785-86b, per State Code 327 IAC 3-6-8-5.
- All PVC joints shall conform to ASTM D3212-96a for elastomeric gasket joints. Gaskets shall conform to ASTM F-477-99.
- Embedment materials for bedding, haunching, and initial backfill, Class 1, 1, or II as described in ASTM D2321-88, Standard Practice for Underground Installation of Thermoplastic Pipe for Sewers and Other Gravity-Flow Applications, shall be used and compacted for all flexible pipe installation per State Code 327 IAC 3-6-8-18g.
- All sewer trenches within the road right-of-way, under parking lots, drives, sidewalks and existing pipes shall be backfilled with #53, #73 aggregates, compacted to 95% Proctor density, unless otherwise noted.
- All permits required for the execution of the work shall be obtained and paid for by the Contractor.
- Contractor to notify Indiana Underground (1-800-382-5544) 48 hours prior to construction for the exact location of existing utilities.
- The sanitary sewer shall have a minimum cover of 4'-0" from the finished grade to the top of the pipe.
- Any existing pipe or pipe(s), which are damaged during construction, shall be replaced with equal or better materials and construction methods.

GENERAL CONSTRUCTION NOTES:

- Any and all field changes to the design/design intent shall immediately be brought to the attention of The LandPlan Group, LLC (TLPG) at (260) 422-2922, prior to execution. Any work done prior to or without such notification shall release TLPG of all responsibilities and liabilities.
- If the contractor, in the course of the work, finds any discrepancies between the plans and the physical conditions of the locality, or any errors or omissions in the plans or in the layout as given by TLPG it shall be his duty to immediately inform TLPG. Any work done after such discovery without authorization will be at contractor's risk.
- Existing utilities shown on plans have been prepared from information available to TLPG, and may not be accurate to extent or locations. Prior to beginning any work, the contractor shall notify utility companies and have them mark or re-mark their facilities.
- The contractor shall obtain all required permits and licenses for execution of the work. All materials and execution of the work shall be in accordance with federal, state and local laws, rules and regulations.
- Contractor responsible for verifying compliance with all setback requirements and zoning conditions prior to construction.
- Grades indicated on plan are approximate only and are to be used to identify elevation relationships. Final grades shall be field determined by contractor and shall allow for positive drainage of all surface areas.
- All paved surfaces including landings and steps are to be sloped at a 1/8" minimum to provide positive drainage away from all structures.
- Contractor responsible for structural integrity of all elements.
- Contractor shall provide expansion joints as required.
- Contractor to determine thickness of wall cavities, amount and location of steel, and footing depth and size of all walls and steps.
- Contractor to ensure all sleeves through walls have a depth below finish grade so as not to be seen. Ensure sleeves are installed below pavement areas.
- H.A.C. pavement types shall conform to INDOT specifications.
- The Contractor is responsible for performing all finish grading in conjunction with seeding the site. The Contractor shall ensure that the finish grade of all lawn and planting areas is flush with the adjacent hardscape elements (such as curbs and walks).
- The Contractor is responsible for providing and installing approved planting soil mix in tree planting pits, shrub planting pits, groundcover areas, and perennial and annual planting areas per the planting details. Approved planting soil mix shall consist of 60% topsoil, 20% Canadian sphagnum peat moss and 20% Coarse, washed sand.
- The Contractor is responsible for providing positive drainage out of all planting islands and planting strips between hardscape elements (such as curbs and walks).

STORM DRAIN NOTES

- All proposed work within road rights-of-way shall be in accordance with the City of Bluffton Street Department Standards and Specifications.
- Storm Drains shall be Polyvinyl Chloride Pipe (PVC) shall conform to ASTM D-3034-97, D-1785-96b.
- Special backfill #73 or #53 to be used within the right-of-way and under driveways.
- It is recommended that the contractor notify Indiana Underground (800-382-5544) 48 hrs. prior to construction for the exact location of existing utilities.
- Connect all downspouts to storm drains as shown, see roof plans for downspout locations. Connections shall be made by sited top with a tee/wye fitting.

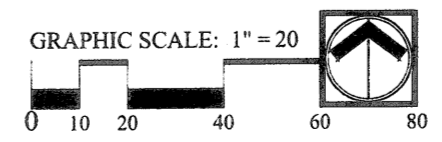
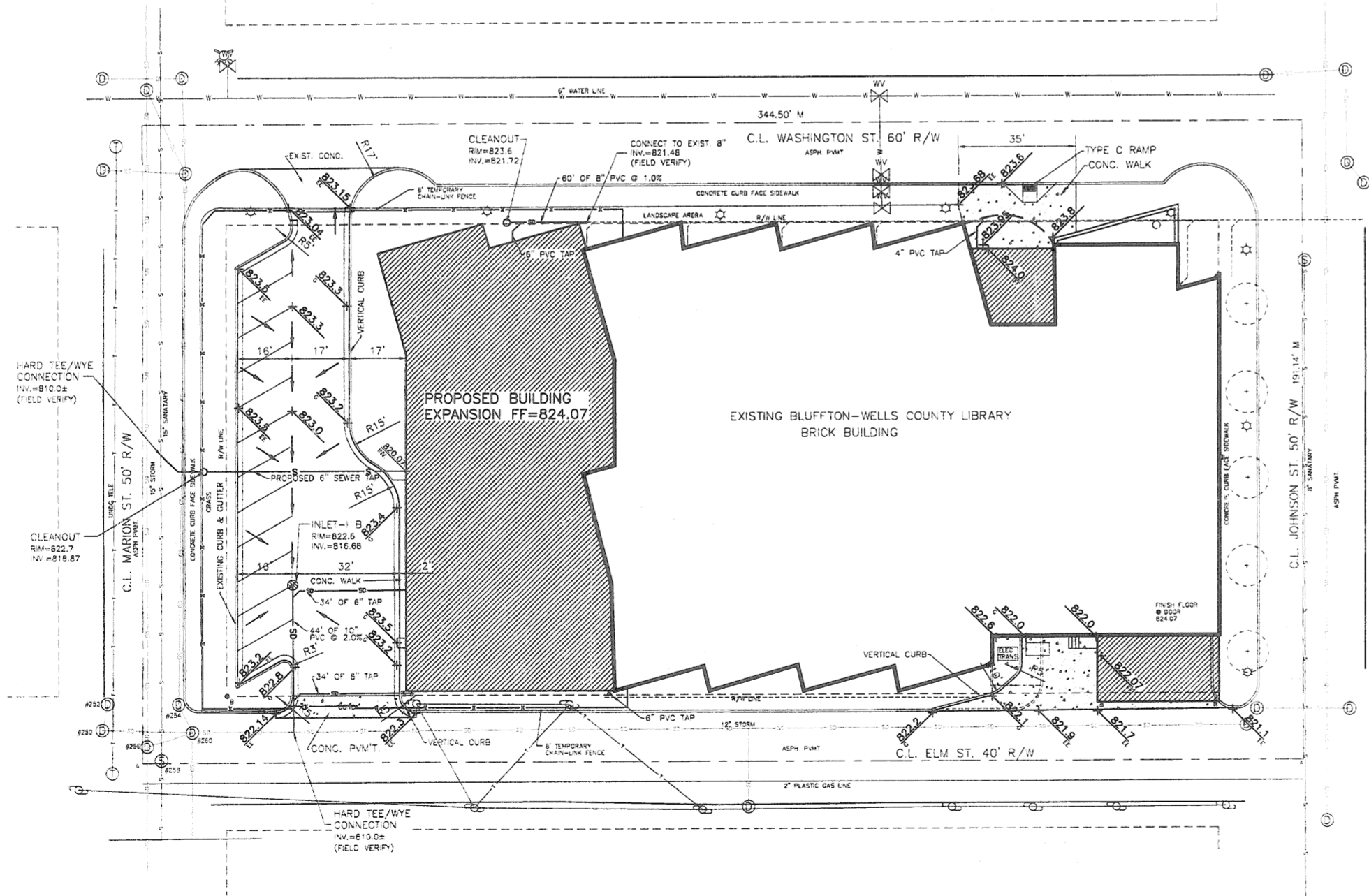

The LandPlan Group, LLC
Planners
Landscape Architects
Civil Engineers
Land Surveyors
Golf Course Architects
108 West Columbia Street
Fort Wayne, Indiana 46802
Phone: 260.422.2922
Fax: 260.422.1832
tlpg@landplangroup.com

REVISION	DATE	BY
x	SCORING NOTES	11/01/2005 MCV
x		
x		
x		
x		
x		

DATE	PROJECT
10-25-2005	2005.0039
TITLE	
SITE DEVELOPMENT PLAN	
SHEET	
C2.0	